

# Quarter Tent Wall Graphic

## Product Parts

1 - Quarter Wall Graphic

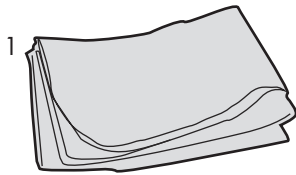

## Note:

*This Quarter Wall Graphic is designed for any of your 10 x 10 tent frames.*

*Graphic may be displayed front or back facing the tent.*



## Display Set-Up

### Step 1

With your tent already set up, remove the Quarter Wall Graphic (1) from bag and set on a clean flat surface.

### Step 2

With the Quarter Wall graphic placed at your desired height and location, begin to loop the four loop straps around the tent legs and secure to the hook strip located on the graphic.

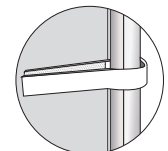
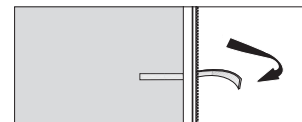

### Step 3

Hook and loop straps may need to be adjusted a couple of times to ensure banner is even and taut on tent.